

ONE BEDROOM APARTMENT
UNIT 304

R1,775,000



Levies* **R1,574 PM**
 Rates* **R1,100 PM**
 Bond Cost* **R17,312 PM**

Total Area **51.28 SQM**
 Internal Area **39.72 SQM**
 Covered Balcony **11.57 SQM**

Location in Building
THIRD FLOOR

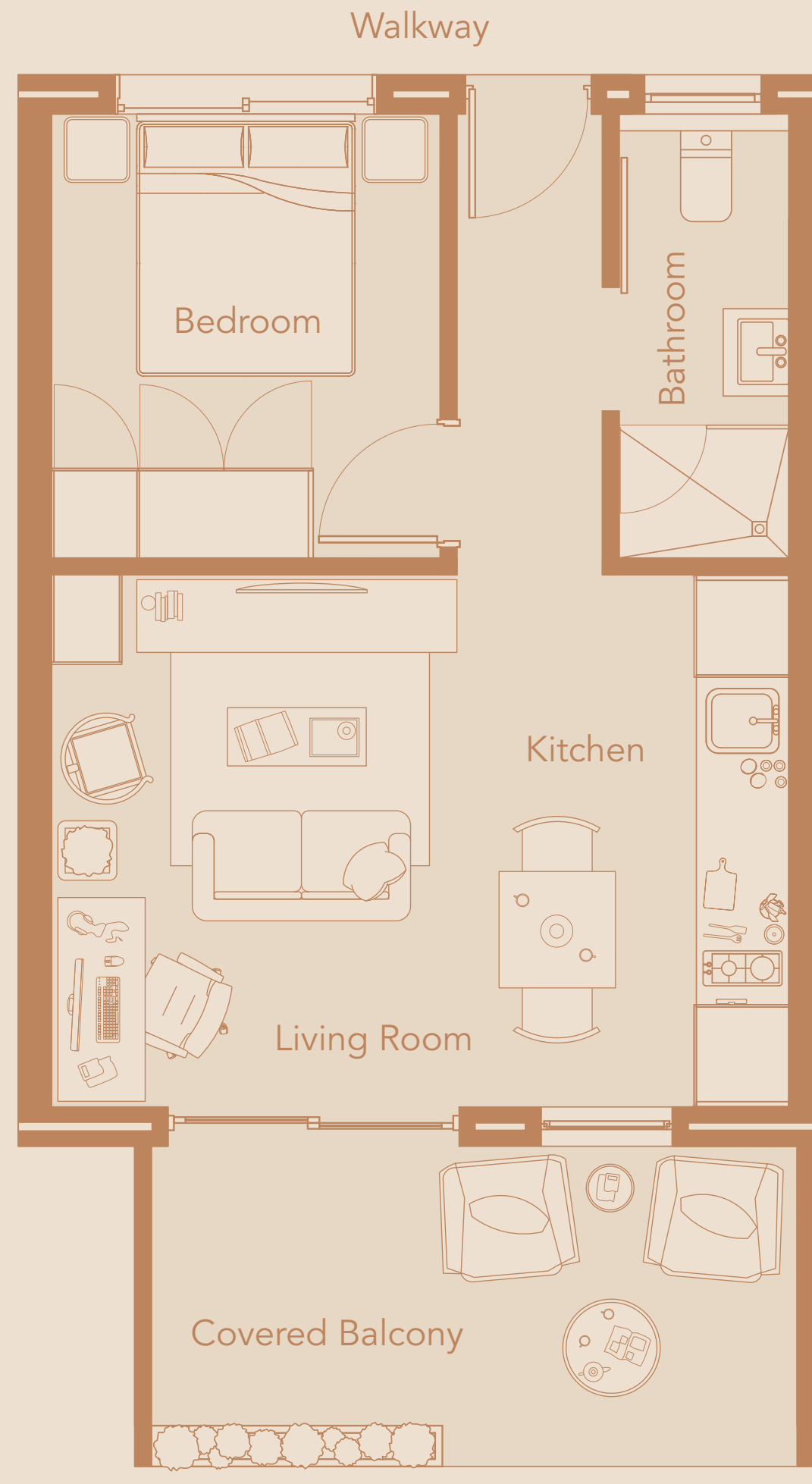
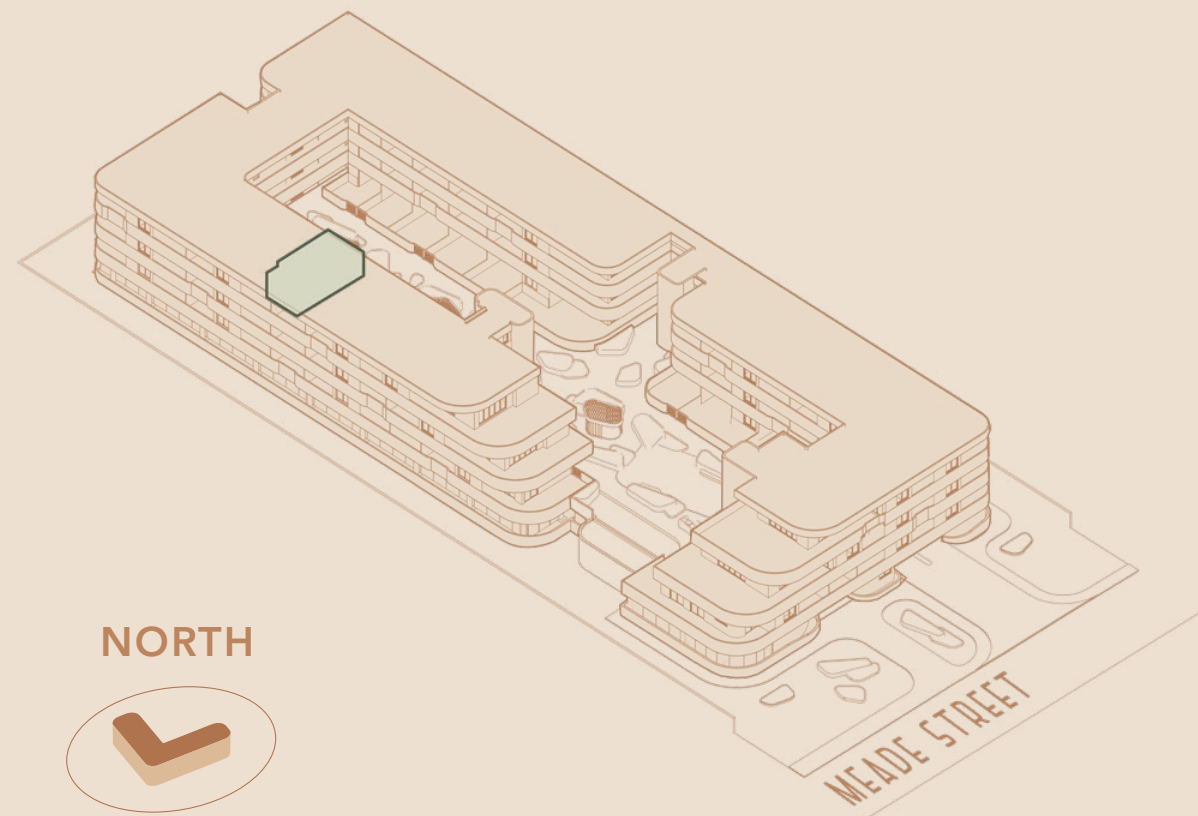

VIEW TO OUTENIQUA

the **MEADE**

* Indicated values are estimates

Estimated bond cost is calculated on 90% finance over 20 years, using the current prime lending rate
 Unit axonometric is an artist's impression, layout may differ slightly | T&C's apply

